

SUNDYNE CORPORATE CAMPUS IMPROVEMENTS

ARVADA, COLORADO

Working Together to Improve

Crestone team members worked side by side with Sundyne staff to determine their needs and requirements which created a more user friendly, efficient, and ergonomic design of this warehouse/loading dock expansion and testing facility project. This approach helped the Sundyne staff to envision the final product and to ensure their utilization expectations were met while allowing for real time design changes.

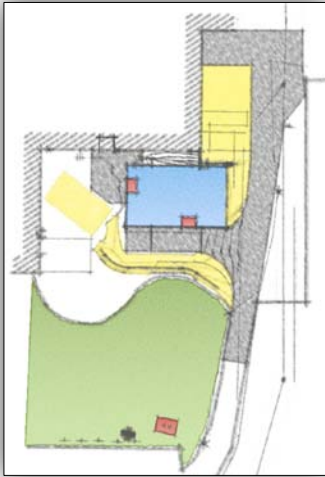

The Project

This \$700,000 project included the addition of a 9,000 sf warehouse building and loading dock and a 100,000 sf test pad facility to the 26 acre Sundyne Corporation World Headquarters Campus in Arvada, Colorado. To meet the requirements of this growing campus, the project accelerated the existing campus master plan to allow for current storage and testing facility demand.



Crestone Performed Services

Our services included the successful development, coordination, and permit processing of construction documents and a stormwater management plan through the City of Arvada. Specific services included:

- Construction Document Preparation
- Cost Analysis
- Drainage Analysis and Design
- Project Coordination
- Site Planning & Layout
- Stormwater Management Plan Preparation
- Surveying Services

**Please contact us for additional project information, references, and recommendations*

